



**SOSSUSVLEI
LODGE**
GATEWAY TO THE NAMIB

*Luxury right at the entrance gate to
Sesriem Canyon & the famous Sossusvlei.*



Sossusvlei Lodge is uniquely located, almost unnoticed, in a vast ocean of unparalleled desert beauty. Shaded by camel thorn trees, the Lodge bears testament to the ingenuity of an eco-friendly design.

The Lodge's Adventure centre provides a variety of exciting activities to discover the Sossusvlei area.

At the Lodge you can take a refreshing dip in the sparkling pool, enjoy an ice cold beer in the unique bar or browse through the curio shop. The al fresco terrace offers magnificent views of the floodlit waterhole where you can watch the passing parade of oryx, springbok, jackal, ground squirrel and hyena, whilst enjoying exquisite food and wine.

Indeed a visual and culinary contrast, bearing in mind the relative remoteness of this exceptional location.

GENERAL INFORMATION

Sossusvlei Lodge opened on 1 September 1994. The official opening of the Lodge by the President of Namibia, His Excellency Dr. Sam Nujoma, followed shortly on 14 October of the same year.

The Lodge is situated on a 40 000 hectare private reserve directly adjacent to the Sesriem gate of the Namib Naukluft Park that is sanctuary to the highest dunes in the oldest desert.

LOCATION

Southern Namibia, amidst the Namib Desert. At the entrance gate to the famous Sossusvlei and Sesriem Canyon.

DISTANCE

750km from Etosha Village and approximately 330km from Windhoek, 360km from Swakopmund and 506km from Lüderitz.

ACCESS

Self-drive: Well-maintained gravel roads from C19 or C27 (Accessible with all vehicles – not only for 4x4 vehicles)

Via air: Approximate 1 hour flight from Windhoek, Swakopmund or Walvis Bay.

FACILITIES

- Restaurant
- Al fresco terrace
- Floodlit waterhole
- Bar and beer garden
- Curio shop
- Swimming pool
- Conference centre
- Lounge
- Adventure centre
- Outdoor catering and functions

SOSSUSVLEI LODGE LANDING STRIP

Coordinates S24°29'22" E015°48'55", elev. 762m (2500'), rwy. 31/13, 1200m (3937')
Compacted gravel; radio freq. 124.8MHz; Avgas refuelling and ablution facilities available.

MAP

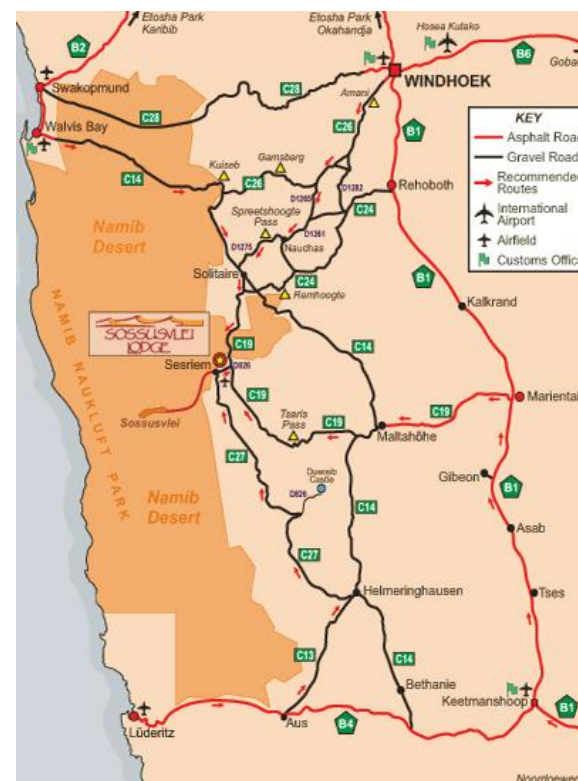

GPS Coordinates: S24°29' 12.1" E015°48' 15.0"



ACCOMMODATION

45 Separate, fully air-conditioned, en-suite bedrooms under canvas with adobe-style plaster walls.

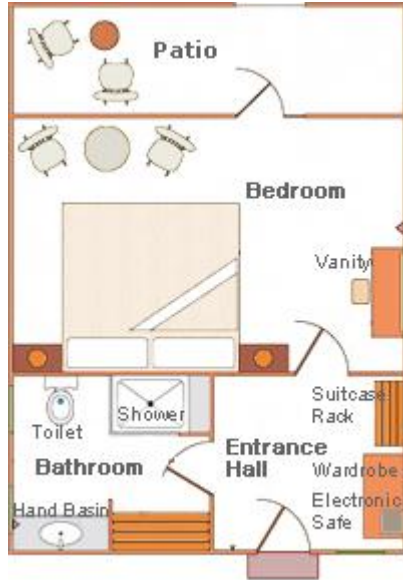

3 Family units, fully air-conditioned, en-suite bedrooms under canvas with adobe-style plaster walls and inter-leading doors in bathrooms to connect the two units.

3 Wheelchair friendly rooms are available. These rooms have open showers with no steps or doors and fitted handles in the bathroom.

ACTIVITIES

- Guided Sossusvlei trips
- Nature drives
- Sun downer trips by 4x4 and quad
- Bush dinners
- Guided sunset walks
- Archery
- Star Gazing
- Hot air ballooning
- Eco friendly quad biking
- Indoor and outdoor conferencing
- Scenic flights
- Charter- and air taxi flights

CONFERENCE FACILITIES

Sossusvlei Lodge offers a unique destination for both indoor and outdoor conferencing in Namibia. Take your conference on holiday! Comprehensive facilities and infrastructure are available with all-inclusive offers.

Indoor conferencing can accommodate up to 100 delegates.

SEASONS

Low season:
1 December - 30 June excluding 24 and 31 December

High season:
1 - 30 November and 1 July - 31 October including 24 and 31 December

AWARDS

Sossusvlei Lodge won several Awards of Excellence in the various categories by the Hospitality Association of Namibia.

Eco Award winner – Acknowledged for adhering strictly to water saving measures, garbage control, nature conservation and minimal power consumption.

CHILD POLICY

One infant and/or child under 12 years shall be accommodated free of charge if accompanying and sharing a room with 2 full paying adults (subject to availability) and subject to payment of the applicable breakfast and dinner rates.

Child Meal Plan:
0 - 4 years | no cost
5 - 11 years | ½ breakfast & dinner cost

CREDIT CARDS

Master and Visa credit cards are welcome.

OWNERS

Taleni Africa Tourism Holdings (Pty) Ltd

GENERAL MANAGER

Karl-Heinz Oosthuizen



RESERVATIONS

Central Reservations Office

Tel: +27 21 930 4564
Fax: +27 21 930 4574

Email: reservations@sossusvleilodge.com

Address: P.O. Box 15109, Panorama, 7506
Cape Town - South Africa

DIRECT DEPOSIT BANKING DETAILS

Bank: Bank Windhoek
Branch Code: 486-372 (Sanlam Centre)
Account Name: Taleni Africa t/a Sossusvlei Lodge
Account Type: Cheque
Account Number: 1065200101
Swift Code: BWL INA NX

Enter the Booking Number on the deposit slip and fax confirmation of deposit to +27 21 930 4574.

TERMS AND CONDITIONS

Quoted rates may change without prior notice should government taxes, fuel prices and other fees increase drastically and unexpectedly. Please confirm all rates.

- All quoted rates are in Namibian Dollars and are inclusive of 15% VAT
- Rates, where stated, are nett and are non-commissionable.
- Rates are quoted per room per night including dinner, bed & breakfast.
- Tariffs quoted are subject to change without prior notice.
- Private reservations will only be regarded as "confirmed" once the stipulated deposit has been received.
- Taleni Africa reserves the right to release a reservation if the due deposit is not received in full by the stipulated deposit due date.
- Full settlement of accommodation reservations must be made 30 days prior to arrival.

The following cancellation policy applies to all reservations:

Cancellation period: Cancellation fee
16 to 30 days prior to arrival: 50%
11 to 15 days prior to arrival: 75%
<10 days prior to arrival: 100%
Non-arrivals: 100%

Tour Operators should contact the Central Reservations Office regarding details of registration.

SOSSUSVLEI LODGE CONTACT DETAILS

Tel: +264 63 293 636
Fax: +264 63 293 645

E-mail: info@sossusvleilodge.com

PO Box 6900, Ausspannplatz, Windhoek – Namibia

www.sossusvleilodge.com

